



# STEALTH VST BLADE KIT

## HOW THE BLADE COMPONENTS WORK

At the heart of the Sabre Stealth VST blade is our ultra-tough Sabre Heavy-Duty Armored Carbide Blade, which has been tested and proven durable enough to handle virtually any plowing scenario. The Sabre\_HD blade is encased in a high-quality rubber compound specifically engineered for use in colder temperatures and to withstand the conditions of municipal plowing.

The patented bolt hole system on the Sabre Stealth blade incorporates a built-in clamp bar and cleverly designed bushings, allowing the user to bolt on and torque the blade down without the need for extra parts while still allowing the blade to flex and absorb vibration.



## FEATURES & BENEFITS

- Simple 3' and 4' blade sections. Besides bolts, no extra parts or adapter blades are needed for installation.
- Suppresses vibrations by 50%, resulting in reduced driver fatigue and minimized wear and tear on equipment.
- Fully-Armored Sabre\_HD blade at the core for extreme durability.
- Incorporated Wear-Indicators assist operators in accurately timing blade changes, enhancing efficiency and maintenance planning.

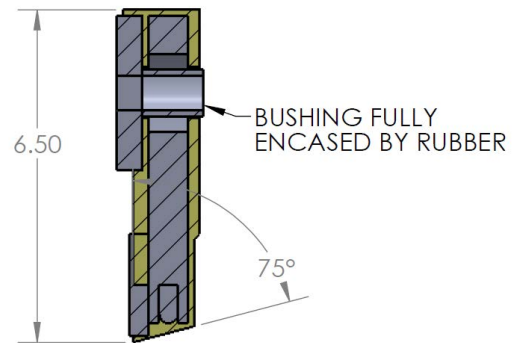

## SABRE STEALTH VST ORDERING INFORMATION - 3/4" CARBIDE INSERT

Available in 3 & 4 ft configurations.

**PART # / Description**

**EVST-SAB-3615** / Sabre Stealth VST - 3' Rubber Encased Sabre 1.5GA SHP

**EVST-SAB-4815** / Sabre Stealth VST - 4' Rubber Encased Sabre 1.5 GA SHP

**EVSTKIT-SAB-120** / Sabre Stealth VST 10' Kit - Encased Carbide & Cover Edge Kit

**EVSTKIT-SAB-132** / Sabre Stealth VST 11' Kit - Encased Carbide & Cover Edge Kit

**EVSTKIT-SAB-144** / Sabre Stealth VST 12' Kit - Encased Carbide & Cover Edge Kit

(KIT = BLADE ASSEMBLY + HEAVY DUTY CAST CARBIDE CURB GUARDS + HARDWARE BOX)

Sabre Stealth VST Kits include Evolution Edges Curb Armor™ curb guard systems.



**VIBRATION SUPPRESSION TECHNOLOGY**



2420 Corning Road Elmira, NY 14903  
EvolutionEdges.com | BuiltBlades.com

Any questions? Please contact us.  
800-733-5508 | Info@EvolutionEdges.com

